

STARLITE INFRACON PVT.LTD.
 Director

Constituted Attorney For
 Rama Chakraborty
 Ranjan Dhall
 Sid Sanjay Mondal
 Avok Kumar Bhattacharya
 Sanjay Nandi
 Smit Kumar Sen

SIGNATURE OF OWNERS

DECLARATION OF E.A.
 I HAVE CERTIFIED ON THE PLAN ITSELF WITH FULL RESPONSIBILITY THAT BUILDING RULES 2017 AS AMENDED FROM TIME TO TIME AND THAT THE SITE CONDITIONS INCLUDING THE ADJOINING ROAD CONFORM WITH THE PLAN AND THAT IT IS A BUILDABLE SITE AND NOT A TANK OR A FILLED UP LAND.
 MUKUL MITTRA
 B. ARCH (HONS.) F.I.A. AIV
 REGISTERED ARCHITECT
 REG. NO. - CA/75/003
 656/RJPSON/EBA/2008-09

SIGNATURE OF ARCHITECT
 MUKUL MITTRA
 B. ARCH (HONS.), F.I.A. AIV
 EMPANELMENT NO. 656/RJPSON/EBA/2008-09

CERTIFICATE OF STRUCTURAL STABILITY
 I HEREBY DECLARE THAT THE FOUNDATION AND SUPER-STRUCTURE OF THE BUILDING PROPOSED FOR CONSTRUCTION ON R.S. DAG NO-3102,3103,3139, LR. 3140,3141,3220,3143,3142, RS 3106,3168 & 3105 KHATIAN NO- RS 666,684/2,468,712,573,63,64,67,64, 1367,1642,411,3115/1 & 1648 J.L. NO-71, MOUZA - JAGADDAL, WARD NO. 25, HOLDING NO- 11 UNDER RAJAPUR, SONARPUR MUNICIPALITY, HARINAVI, KOLKATA - 700 148, HAVE BEEN SO DESIGNED BY ME THAT IT WILL MAKE SUCH FOUNDATION AND SUPER-STRUCTURE SAFE IN ALL RESPECT INCLUDING THE CONSIDERATION OF BEARING CAPACITY OF SOIL ETC.

BIBEK BIKASH MULLICK
 Rajpur Sonarpur Municipality
 E.S.E. 021

SIGNATURE OF STRUCTURAL ENGINEER
 BIBEK BIKASH MULLICK
 B.E. (CIVIL), M.E. (STRUCTURE)
 EMPANELMENT NO. - ESE-021

KAUSHIK SENGUPTA
 B.E. (CIVIL), M.E. (STRUCTURE)
 EMPANELMENT NO. - ESF-007

SIGNATURE OF STRUCTURAL REVIEWER
 KAUSHIK SENGUPTA
 B.E. (CIVIL), M.E. (STRUCTURE)
 EMPANELMENT NO. - ESF-039

ALOK ROY
 Registered Geotechnical Engineer
 Rajpur - Sonarpur Municipality

SIGNATURE OF GEOTECHNICAL ENGINEER
 ALOK ROY
 B.E. (CIVIL), M.C.E. (FOUNDATION ENGG.)
 EMPANELMENT NO. - GR/509

PROJECT TITLE
 PROPOSED G+XII, G+V(2NOS), G+IV STORIED RESIDENTIAL BUILDING AT R.S. DAG NO - 3102,3103,3139, LR3140,3141,3220,3143,3142,RS 3106,3168 & 3105 KHATIAN NO- RS 666,684/2,468,712,573,63,60, 643,674,1367,1642,411,3115/1 & 1648 J.L. NO- 71, MOUZA - JAGADDAL, WARD NO- 25, HOLDING NO- 11, DR. B.C. ROY ROAD UNDER RAJAPUR SONARPUR MUNICIPALITY, HARINAVI, KOLKATA - 700 148. PREV. SANC. NO. : 1297/CB/25/21 DATED - 13/01/2014

NAME OF OWNER = M/S STARLITE INFRACON PVT LTD & OTHERS

TITLE : BLOCK - D (G+XII)

TYPICAL FLOOR BEAM G.A. BEAM & SLAB SCHEDULE

PROJECT ARCHITECT :-
 CONSULTANTS FOR HUMAN SETTLEMENT
 FLAT-38, 7TH FLOOR, 103 Park Street, Kolkata-700016
 TEL:-91-33-22612564, E-mail : sagana.shelton@gmail.com
 164/B Becharam Chatterjee Street, Kolkata-700061 366 Anna Salda, Teyanpet, Chennai-600018

DEALT BY: SUMITA
 SCALE : 1:100, 1:25
 DATE : 08.08.2017
 DRG. NO. : D/S/18/11/2017

OFFICE USE ONLY

Building Plan No. 156/Kol/2017/149 Dated On: 19/11/2018
 for record of the Rajpur-Sonarpur Municipality without Verification No. deviation from the submitting structural plan should be made at the time of erection without submitting fresh structural plan along with design calculation and stability certificate in the prescribed form necessary steps should be taken for the safety of the adjoining premises public private properties and safety of human life during Construction.

Sig. of Assistant Engineer
 Incharge F.W.D
 RAJAPUR SONARPUR MUNICIPALITY

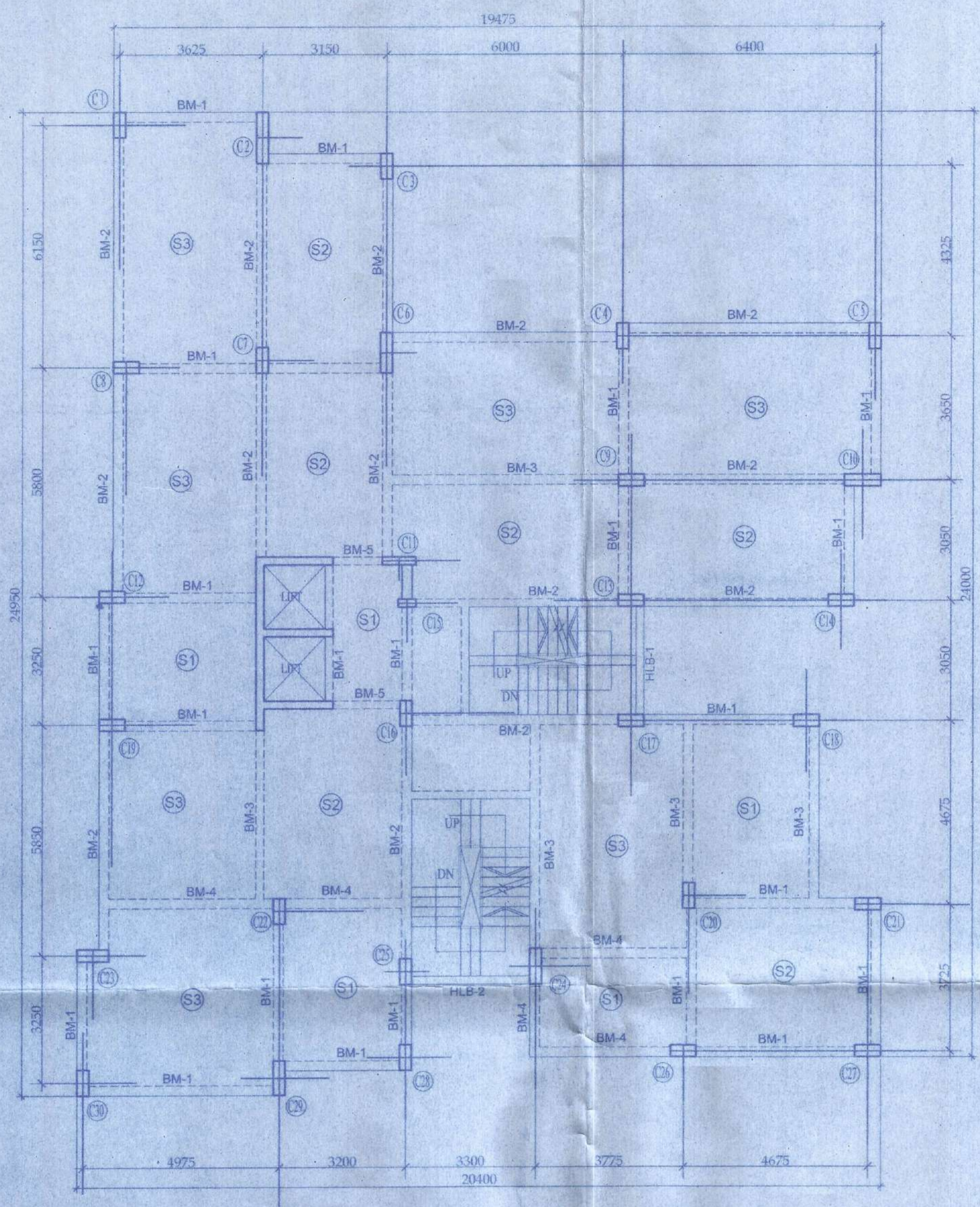

TYPICAL FLOOR BEAM G.A.
 1ST TO 7TH & 9TH TO 11TH FLOOR
 SCALE 1:100

TYPICAL FLOOR BEAM SCHEDULE:-

BEAM MKD.	BEAM SIZE	SUPPORT REINFORCEMENT			SPAN REINFORCEMENT		
		TOP	BOTTOM	STIRRUPS	TOP	BOTTOM	STIRRUPS
BX-1	250X500	3-20T	3-16T	8T@115 C/C	2-20T	3-20T	8T@200 C/C
BX-2	250X500	3-25T	3-16T	8T@115 C/C	2-25T	3-25T	8T@200 C/C
BX-3	250X500	3-20T	3-16T	8T@115 C/C	3-20T	3-20T	8T@200 C/C
BX-4	250X500	3-20T	3-16T	8T@115 C/C	3-20T	3-20T	8T@200 C/C
BX-5	200X500	3-25T	3-16T	8T@150 C/C	2-20T	3-20T	8T@250 C/C
HLB-1	200X400	3-20T	3-20T	8T@150 C/C	2-20T	3-20T	8T@250 C/C
HLB-2	250X400	3-20T	3-20T	8T@150 C/C	2-20T	3-20T	8T@250 C/C

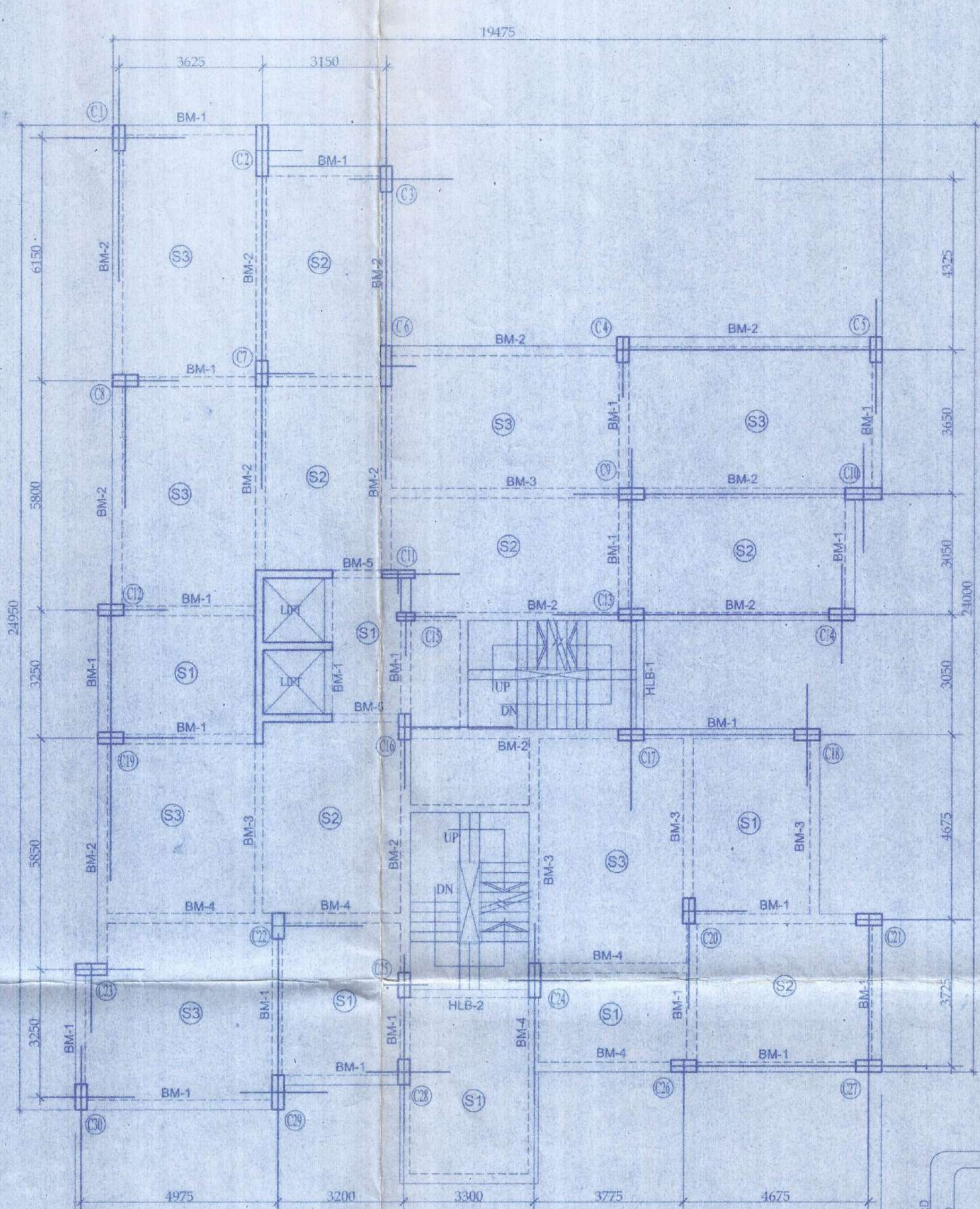

8TH & 12TH FLOOR BEAM G.A.
 SCALE 1:100

FLOOR SLAB SCHEDULE:-

SLAB THK.	SHORTER SPAN		LONGER SPAN	
	SUPPORT TOP	MID SPAN BOTTOM	SUPPORT TOP	MID SPAN BOTTOM
100	8 T @ 150 C/C	8 T @ 200 C/C	8 T @ 150 C/C	8 T @ 200 C/C
115	8 T @ 150 C/C	8 T @ 175 C/C	8 T @ 150 C/C	8 T @ 200 C/C
125	8 T @ 125 C/C	8 T @ 175 C/C	8 T @ 150 C/C	8 T @ 200 C/C

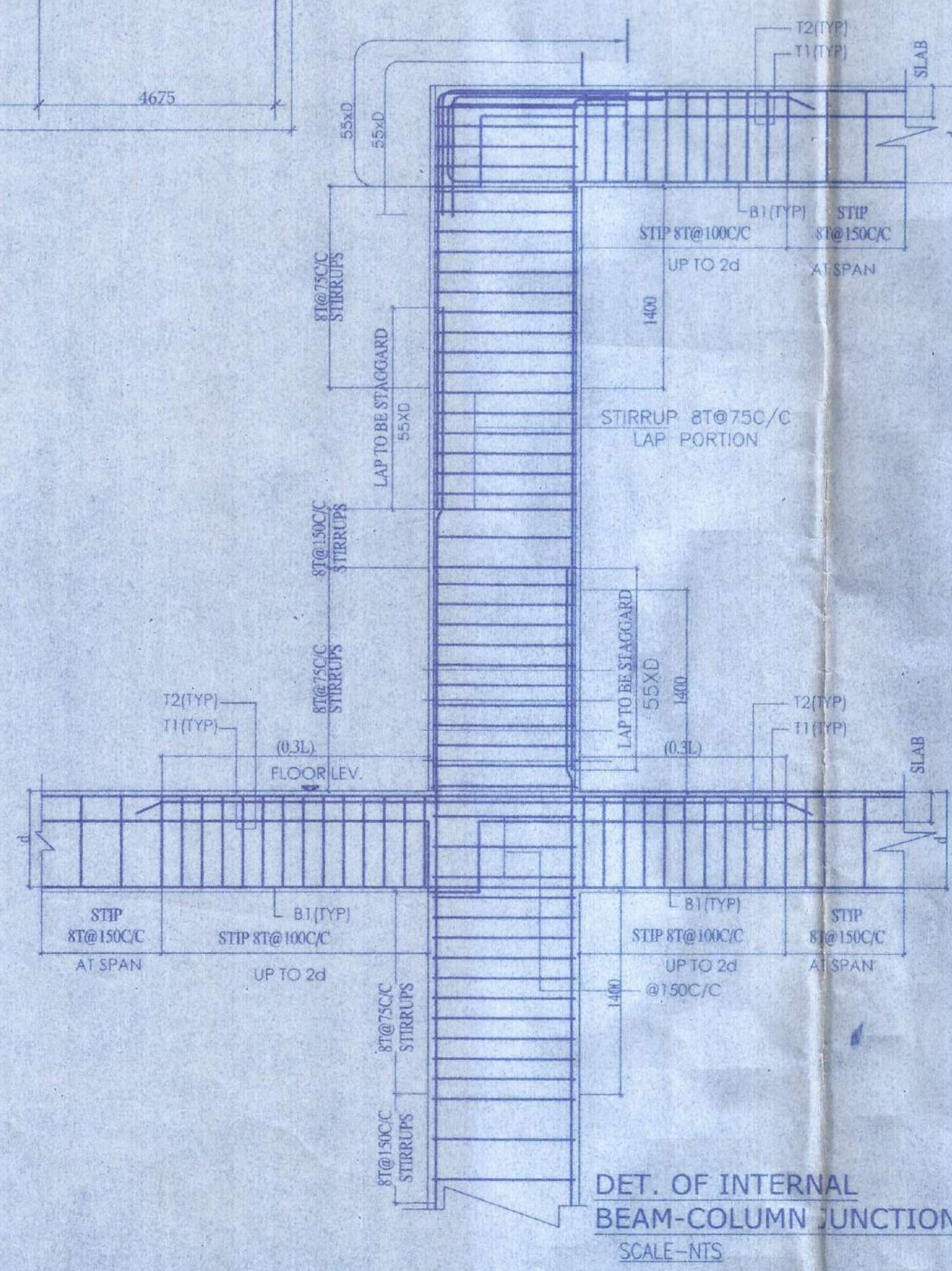

DET. OF INTERNAL BEAM-COLUMN JUNCTION
 SCALE-1:25

